

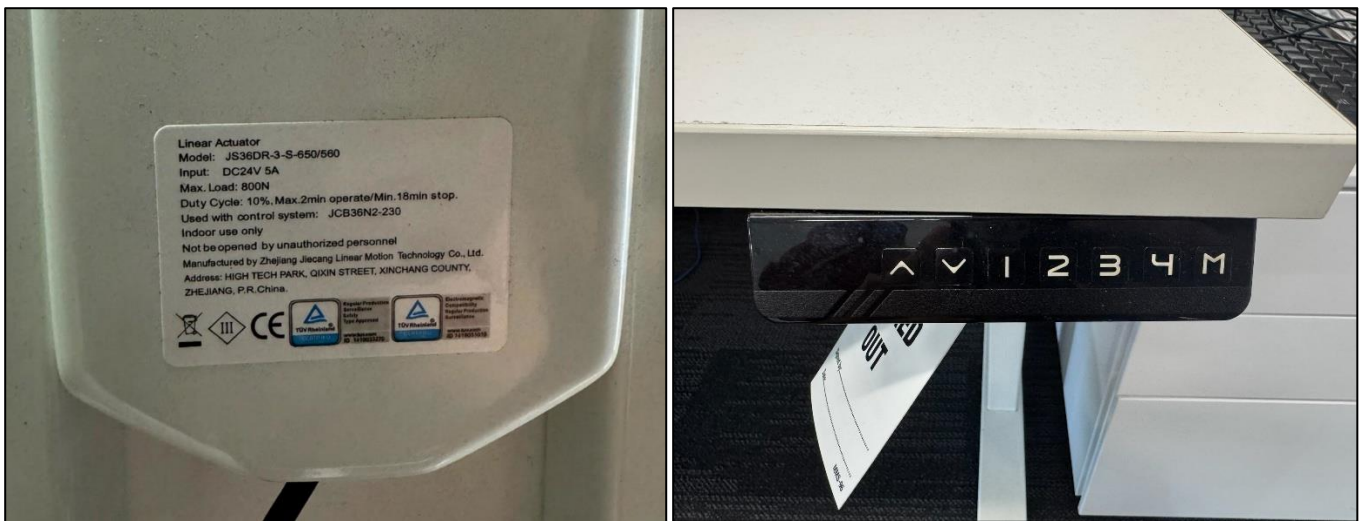

## Sit-stand desk electrical hazard

### Background

Certain sit-stand desks installed in the Chifley Library have been found to have a flawed electrical design. This design flaw can create the risk of a minor electric shock. These desks are unbranded but use a Linear Actuator (model JS36DR-3-s-650/560) and a Control System (model JCB36N2-230), manufactured by Zhejiang Jiechang Linear Motion Technology Co. Ltd.



### Recommendations

If you suspect that this type of sit-stand desk is present in an ANU facility:

- **Unplug any desk suspected to be faulty and tag it out immediately.**
- **Report the hazard** by lodging a Figtree Hazard noting the location and number of desks suspected to be faulty.
- **Coordinate with your local management and Campus Environment to test any suspected faulty desk** by a licensed electrician.
- **Circulate this information to others** as an agenda item for any upcoming meetings and add it to the local safety notice board.

### Additional Information

- [Information](#) on what to do in case of an electric shock
- [Information](#) on the effects of an electric shock including concerns for individuals with specific health issues/concerns

**Take down:** 3-6 months from issue date

**Intended Audience:** All ANU

**Contact:** [whs@anu.edu.au](mailto:whs@anu.edu.au) for additional information

**Authorised by:** Deputy Chief People Officer - Safety and Wellbeing